

Rigid PVC Pipe and Fittings with anti water condensation layer for air conditioning drainage

ESLON® AC DRAIN PIPE

ESLON® AC DRAIN Fittings

ESLON® Transparent AC DRAIN Fittings

**No Insulation
Work Required!**



Most suitable piping material for air conditioning drainage is

Eslon AC Drain Pipe and Fittings prevent water condensation and do not require any insulation work. It is a perfect fit for air conditioning drainage in office, hotel and hospital, etc.

Problems

on conventional air conditioning drainage.

Eslon AC Drain Pipe & Fittings solve all problems!

Insulation work

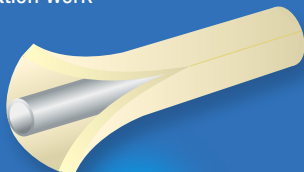

It is a time consuming for insulation work.

Secure the installation



Cannot check joint and slope angle.

Threading work



Threading is painful work.

Do not need insulation work

Eslon AC Drainage Pipe and Fittings have a function of thermal insulation. Therefore you do not need any insulation work.

Conventional Method

Multiple operations were required.

In case of Packaging Air Conditioning

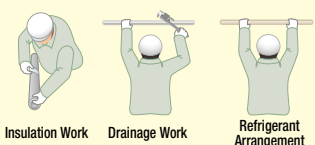

Insulation Work Drainage Work Refrigerant Arrangement

In case of Fan Coil Unit

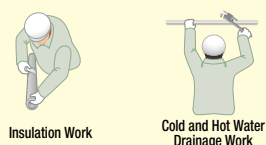

Insulation Work Cold and Hot Water Drainage Work

With AC Drain

Refrigerant, Drainage, Insulation Work,

Cold and Hot Water, Drainage and Insulation Work,

Multiple works can be eliminated.

AC Drains is effective to reduce installation time.

Easy to Install and Improve the Quality

Installation is identical to a conventional DV connection. There is no outer insulation material. Therefore, inspection work on joint and slope setting is much easy. In addition, visual inspection and securing the joint works are feasible by using Transparent Fittings.

Cost Saving

Eslon AC Drain Pipe and Fittings System is economical because of easy installation and elimination of insulation work.

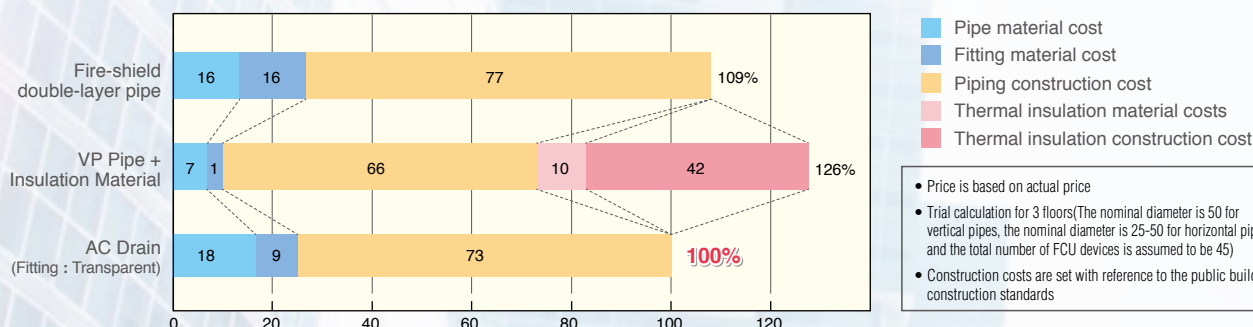

AC Drain Pipe and Fittings!

Water condensation is prevented by foamed layer.

Both Pipe and Fittings have a foamed insulation layer. This prevents whole plumbing from water condensation without having outer insulation material.

Fitting (Injection Molded Foam Products)

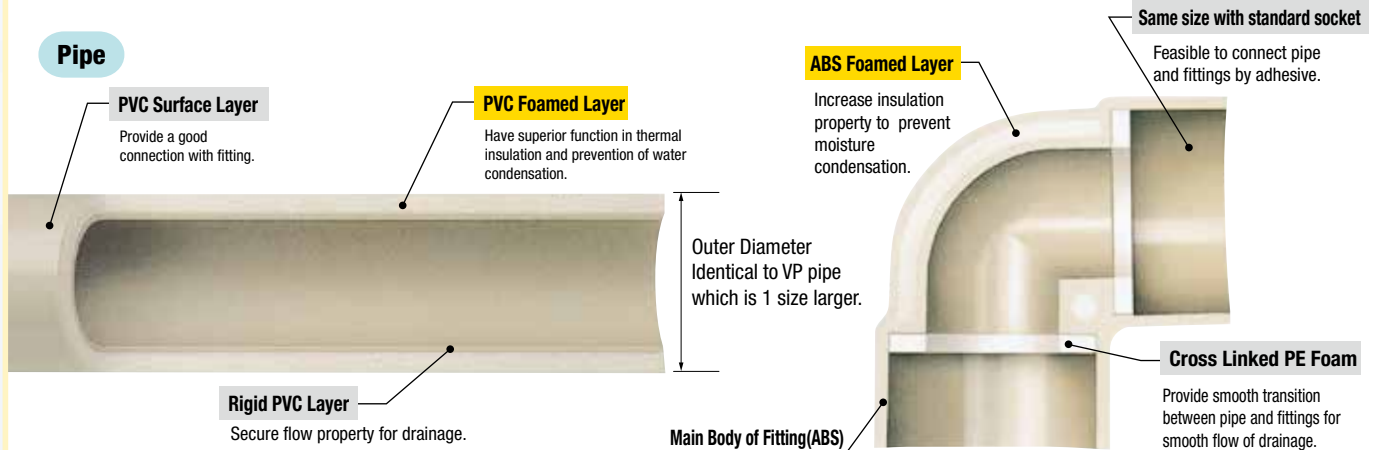

Can be applied for air conditioning drainage regardless whether the system is packaged air conditioner or fan coil unit.

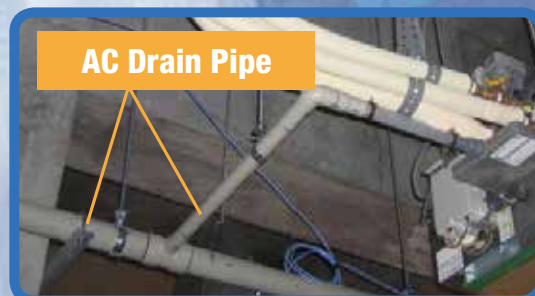
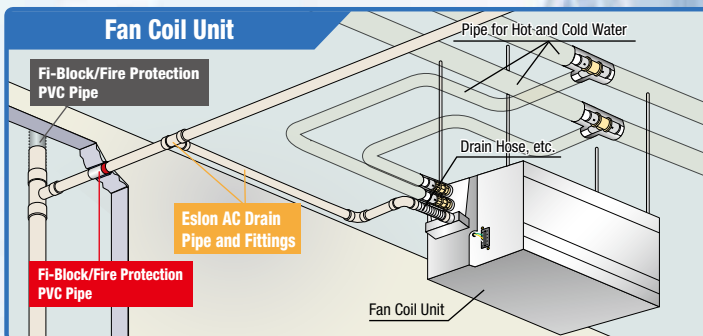
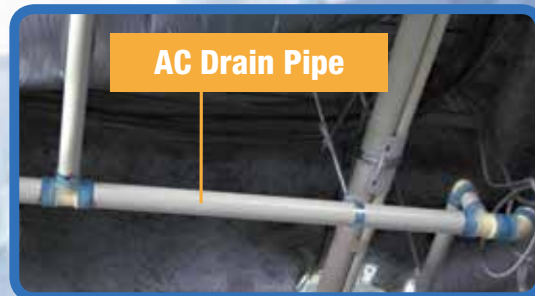
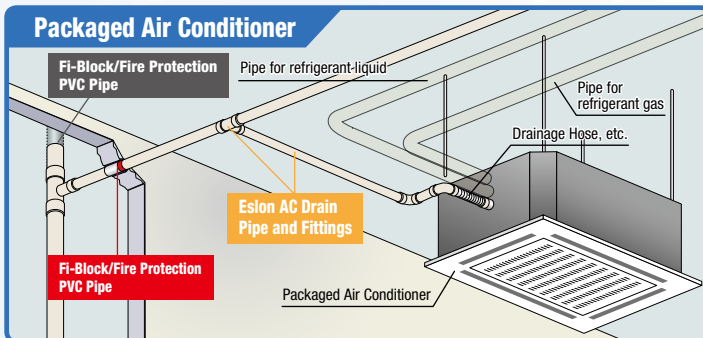

⚠ Arrange thermal insulation in principle for pump up section. Some conditions may not require, but please check and determine properly.

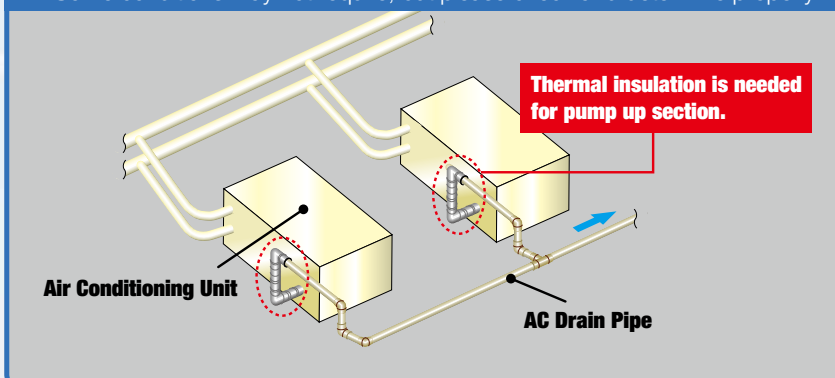

Applicable Range

| Category | Condition |
|-------------------|-------------------------------|
| Application | for Air Conditioning Drainage |
| Water Pressure | Under no pressure (Note) |
| Water Temperature | Normal Temperature (5-35°C) |
| Nominal Diameter | 20-50 |

Note: Except pump up whose length is less than 1 meter

Mark in this brochure

- ⚠ Caution** In case left hand mark is stated, it may cause serious injury or burn wound unless properly treated.
- !** Items with left hand mark is precaution statement to secure the performance of material

**New
Line Up!!**

Transparent AC Drain Fittings

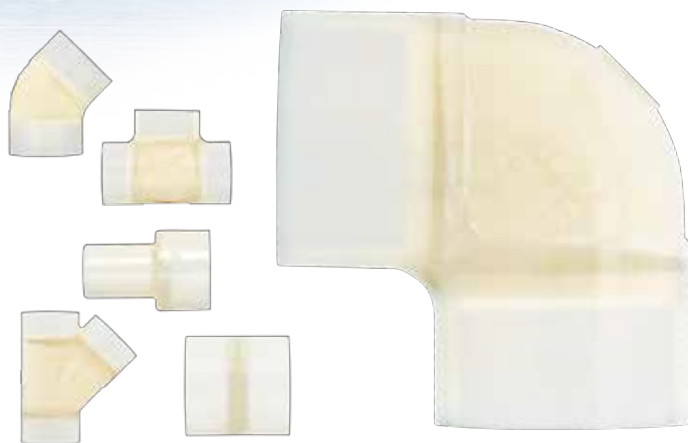
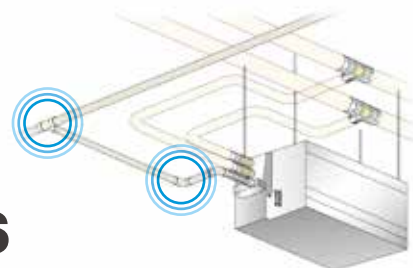

Structure

Transparent Material(ABS)

Easy to conduct visual check to avoid insufficient adhesive or insufficient insertion.

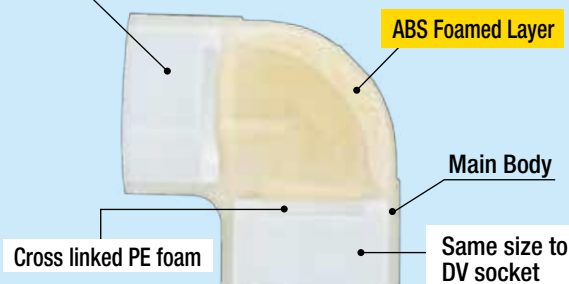

Easy to check connecting condition

Refer Page 4, 5, 6, 7
for product line and specification.

Feature

**○ Proper
connecting condition**

**✗ Not inserted
sufficiently**

**✗ No adhesive
was applied**

In case of Adhesive Blue

Adhesive
No. 73S
Blue



Adhesive
No. 75S
Blue N



In case of luminous adhesive

NEW

Adhesive
No.73S UV

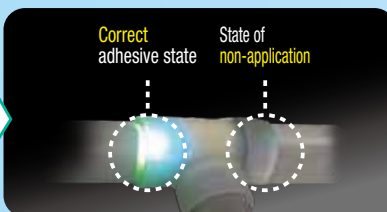

Be sure to use adhesive No.73S Blue, No.75S Blue N, or No.73S UV for transparent AC drain fittings.

Example of plumbing

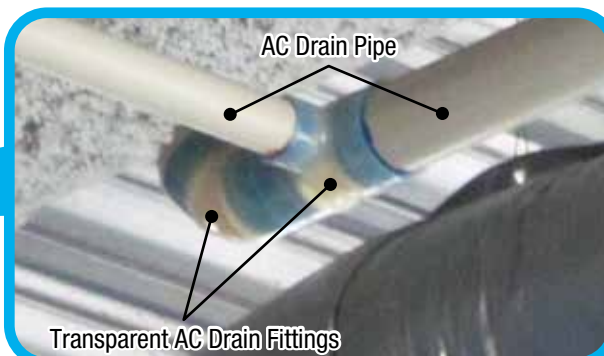

Eslon AC Drain Pipe and Fittings Product Lineup

Straight Pipe

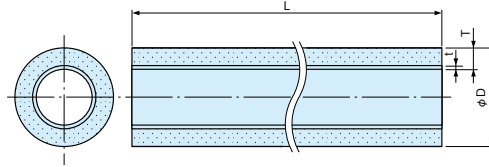

Munsell No. 2.5Y7.5/1

Unit:mm

| Product Number | Nominal Diameter | Outer Diameter φD | Tube Thickness T | Thickness of Rigid PVC Layer t | Approximate inner diameter (reference) | Length L | Reference Mass (kg/m) | Quantity per Package | Price |
|-------------------|------------------|-------------------|------------------|--------------------------------|--|----------|-----------------------|----------------------|------------|
| ACD20P | 20 | 32.0 | 6.5 | 1.7 | 19.0 | 4,000 | 0.32 | 16 | 3,450 yen |
| ACD25P | 25 | 38.0 | 6.5 | 2.0 | 25.0 | | 0.50 | 12 | 3,864 yen |
| ACD30P | 30 | 48.0 | 8.5 | 2.0 | 31.0 | | 0.72 | 9 | 4,830 yen |
| ACD40P | 40 | 60.0 | 9.0 | 2.2 | 42.0 | | 1.00 | 6 | 6,279 yen |
| ACD50P | 50 | 76.0 | 9.5 | 2.5 | 57.0 | | 1.41 | 4 | 8,211 yen |
| NEW ACD65P | 65 | 89.0 | 10.0 | 2.6 | 69.0 | | 1.77 | 4 | 11,286 yen |

Fittings

Socket Dimensions (Common)

●Foam Injection Moldings

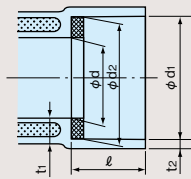

●Injection Molded Products

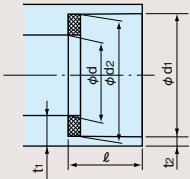

Unit:mm

| Nominal Diameter | Inner Diameter | | | Socket Length Z | Thickness t1 (minimum) | Socket Thickness t2 (minimum) |
|------------------|----------------|------------|------|-----------------|------------------------|-------------------------------|
| | φd1 | φd2 | φd | | | |
| 20 | 32.25±0.25 | 31.85±0.25 | 19.0 | 23 | 8.5 | 2.7 |
| 25 | 38.25±0.25 | 37.85±0.25 | 25.0 | 23 | 8.5 | 2.7 |
| 30 | 48.30±0.30 | 47.80±0.30 | 31.0 | 27 | 0.7 | 2.7 |
| 40 | 60.35±0.30 | 59.75±0.30 | 42.0 | 30 | 9.1 | 3.1 |
| 50 | 76.40±0.30 | 75.70±0.30 | 57.0 | 40 | 9.4 | 3.1 |
| NEW 65 | 89.45±0.30 | 88.65±0.30 | 69.0 | 44 | 10.0 | 3.6 |

<ABS Foam Injection Molded Product>

90 °Elbow

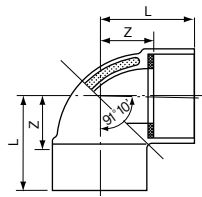

Unit:mm

| Nominal Diameter | Effective Length Z | Full Length L | Quantity per Package | Ivory Colored | | Transparent | |
|------------------|--------------------|---------------|----------------------|---------------|-----------|-------------|-----------|
| | | | | No. | Price | No. | Price |
| 20 | 23 | 42 | 80 | ACL20N | 621 yen | ACL20S | 713 yen |
| 25 | 26 | 45 | 160 | ACL25N | 665 yen | ACL25S | 759 yen |
| 30 | 31 | 54 | 100 | ACL30N | 786 yen | ACL30S | 909 yen |
| 40 | 37 | 63 | 50 | ACL40N | 1,076 yen | ACL40S | 1,242 yen |
| 50 | 46 | 82 | 20 | ACL50N | 1,265 yen | ACL50S | 1,461 yen |
| NEW 65 | 52 | 92 | 16 | ACL65N | 1,610 yen | ACL65S | 1,850 yen |

45 °Elbow

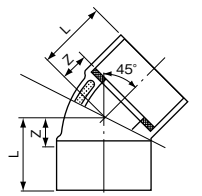
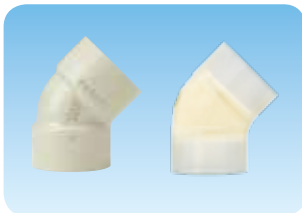

Unit:mm

| Nominal Diameter | Effective Length Z | Full Length L | Quantity per Package | Ivory Colored | | Transparent | |
|------------------|--------------------|---------------|----------------------|---------------|-----------|-------------|-----------|
| | | | | No. | Price | No. | Price |
| 20 | 14 | 33 | 80 | AC4L20N | 621 yen | AC4L20S | 713 yen |
| 25 | 16 | 35 | 160 | AC4L25N | 665 yen | AC4L25S | 759 yen |
| 30 | 18 | 41 | 100 | AC4L30N | 786 yen | AC4L30S | 909 yen |
| 40 | 22 | 48 | 60 | AC4L40N | 1,076 yen | AC4L40S | 1,242 yen |
| 50 | 26 | 62 | 30 | AC4L50N | 1,265 yen | AC4L50S | 1,461 yen |
| NEW 65 | 29 | 69 | 20 | AC4L65N | 1,610 yen | AC4L65S | 1,850 yen |

Tees

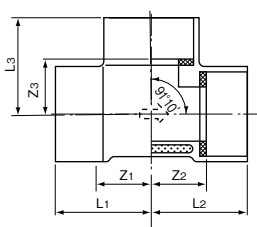

Unit:mm

| Nominal Diameter | Effective Length | | | Full Length | | | Quantity per Package | Ivory Colored | | Transparent | |
|------------------|------------------|----|----|-------------|----|----|----------------------|---------------|-----------|-------------|-----------|
| | Z1 | Z2 | Z3 | L1 | L2 | L3 | | No. | Price | No. | Price |
| 20 | 23 | 23 | 23 | 42 | 42 | 42 | 40 | ACT20N | 748 yen | ACT20S | 851 yen |
| 25 | 26 | 26 | 26 | 45 | 45 | 45 | 100 | ACT25N | 786 yen | ACT25S | 897 yen |
| 25×20 | 23 | 23 | 26 | 42 | 42 | 45 | 40 | ACT251N | 874 yen | ACT251S | 1,001 yen |
| 30 | 31 | 31 | 31 | 54 | 54 | 54 | 60 | ACT30N | 907 yen | ACT30S | 1,035 yen |
| 30×20 | 23 | 23 | 31 | 46 | 46 | 50 | 24 | ACT302N | 907 yen | ACT302S | 1,035 yen |
| 30×25 | 26 | 26 | 31 | 49 | 49 | 50 | 60 | ACT301N | 907 yen | ACT301S | 1,035 yen |
| 40 | 38 | 38 | 38 | 64 | 64 | 64 | 30 | ACT40N | 1,265 yen | ACT40S | 1,461 yen |
| 40×20 | 23 | 23 | 38 | 49 | 49 | 57 | 20 | ACT403N | 1,208 yen | ACT403S | 1,380 yen |
| 40×25 | 26 | 26 | 37 | 52 | 52 | 56 | 40 | ACT402N | 1,208 yen | ACT402S | 1,380 yen |
| 40×30 | 31 | 31 | 37 | 57 | 57 | 60 | 40 | ACT401N | 1,208 yen | ACT401S | 1,380 yen |
| 50 | 46 | 46 | 46 | 82 | 82 | 82 | 20 | ACT50N | 1,668 yen | ACT50S | 1,921 yen |
| 50×20 | 23 | 24 | 46 | 59 | 60 | 65 | 20 | ACT504N | 1,610 yen | ACT504S | 1,840 yen |
| 50×25 | 26 | 27 | 46 | 62 | 63 | 64 | 20 | ACT503N | 1,610 yen | ACT503S | 1,840 yen |
| 50×30 | 31 | 32 | 46 | 67 | 68 | 69 | 20 | ACT502N | 1,610 yen | ACT502S | 1,840 yen |
| 50×40 | 38 | 39 | 46 | 74 | 75 | 72 | 20 | ACT501N | 1,610 yen | ACT501S | 1,840 yen |
| NEW 65 | 52 | 53 | 52 | 93 | 94 | 93 | 10 | ACT65N | 2,120 yen | ACT65S | 2,440 yen |
| NEW 65×25 | 28 | 29 | 53 | 68 | 69 | 72 | 18 | ACT654N | 1,940 yen | ACT654S | 2,440 yen |
| NEW 65×30 | 33 | 34 | 53 | 73 | 74 | 76 | 16 | ACT653N | 1,940 yen | ACT653S | 2,440 yen |
| NEW 65×40 | 40 | 41 | 53 | 80 | 81 | 79 | 14 | ACT652N | 1,940 yen | ACT652S | 2,440 yen |
| NEW 65×50 | 46 | 47 | 53 | 86 | 87 | 89 | 12 | ACT651N | 1,940 yen | ACT651S | 2,440 yen |

Eslon AC Drain Pipe and Fittings Product Lineup

45 °Y

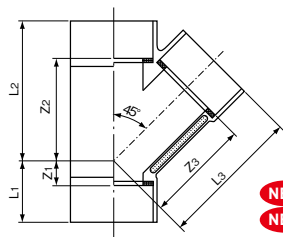

NEW
NEW

| Nominal Diameter | Effective Length | | | Full Length | | | Quantity per Package | Ivory Colored | | Transparent | |
|------------------|------------------|-----|-----|-------------|-----|-----|----------------------|---------------|-----------|-------------|-----------|
| | Z1 | Z2 | Z3 | L1 | L2 | L3 | | No. | Price | No. | Price |
| 30 | 16 | 62 | 66 | 39 | 85 | 89 | 30 | ACY30N | 1,495 yen | ACY30S | 1,725 yen |
| 40 | 24 | 76 | 82 | 50 | 102 | 108 | 25 | ACY40N | 1,610 yen | ACY40S | 1,852 yen |
| 50 | 24 | 96 | 102 | 60 | 132 | 138 | 14 | ACY50N | 1,725 yen | ACY50S | 1,990 yen |
| 50x40 | 12 | 84 | 92 | 48 | 120 | 118 | 15 | ACY501N | 1,668 yen | ACY501S | 1,921 yen |
| NEW 65 | 30 | 110 | 119 | 70 | 150 | 161 | 8 | ACY65N | 2,190 yen | ACY65S | 2,520 yen |
| NEW 65x50 | 18 | 102 | 110 | 58 | 142 | 146 | 8 | ACY651N | 2,120 yen | ACY651S | 2,440 yen |

Unit:mm

<Rigid PVC Injection Molded Product>

Socket

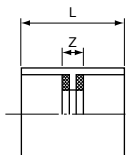

NEW

| Nominal Diameter | Effective Length Z | Full Length L | Quantity per Package | Ivory Colored | | Transparent | |
|------------------|--------------------|---------------|----------------------|---------------|-----------|-------------|-----------|
| | | | | No. | Price | No. | Price |
| 20 | 11 | 49 | 120 | ACS20N | 495 yen | ACS20S | 541 yen |
| 25 | 11 | 49 | 240 | ACS25N | 544 yen | ACS25S | 598 yen |
| 30 | 11 | 57 | 160 | ACS30N | 628 yen | ACS30S | 690 yen |
| 40 | 11 | 63 | 80 | ACS40N | 907 yen | ACS40S | 978 yen |
| 50 | 11 | 83 | 40 | ACS50N | 1,027 yen | ACS50S | 1,116 yen |
| NEW 65 | 12 | 92 | 10 | ACS65N | 1,300 yen | ACS65S | 1,420 yen |

Unit:mm

Reducing Socket

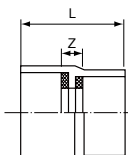
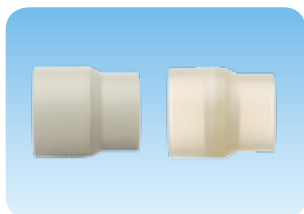

NEW

| Nominal Diameter | Effective Length Z | Full Length L | Quantity per Package | Ivory Colored | | Transparent | |
|------------------|--------------------|---------------|----------------------|---------------|-----------|-------------|-----------|
| | | | | No. | Price | No. | Price |
| 25x20 | 13 | 51 | 80 | ACS251N | 518 yen | ACS251S | 564 yen |
| 30x25 | 12 | 54 | 180 | ACS301N | 628 yen | ACS301S | 690 yen |
| 40x30 | 13 | 62 | 100 | ACS401N | 907 yen | ACS401S | 978 yen |
| 50x40 | 13 | 75 | 60 | ACS501N | 1,027 yen | ACS501S | 1,116 yen |
| NEW 65x50 | 13 | 89 | 10 | ACS651N | 1,300 yen | ACS651S | 1,420 yen |

Unit:mm

Adapter (Transition Fitting to PVC Pipe)

Nominal Diameters 20, 25

Nominal Diameters 30, 40, 50

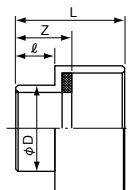

Remarks: 1. Please refer to page 11 for how to use.

2. Connect an AC drain pipe of the same nominal diameter to the socket side. Connect TS fittings to the spigot side with nominal diameters of 20 and 25, and connect DV fittings to the spigot side with nominal diameters of 30, 40 and 50 (as these are for use with DV socket measurements, TS fittings cannot be used).

Unit:mm

| Nominal Diameter | Effective Length Z | Spigot φD | ℓ | Full Length L | Spigot Side Connection Fitting | Quantity per Package | Ivory Colored | | Transparent | |
|------------------|--------------------|-----------|----|---------------|--------------------------------|----------------------|---------------|---------|-------------|---------|
| | | | | | | | No. | Price | No. | Price |
| 20 | 41 | 26.0 | 34 | 60.0 | TS20 | 100 | ACDA20 | 276 yen | ACA20S | 299 yen |
| 25 | 46 | 32.0 | 39 | 65.0 | TS25 | 80 | ACDA25 | 288 yen | ACA25S | 322 yen |
| 30 | 24 | 38.0 | 17 | 47.5 | DV30 | 80 | ACDA30 | 345 yen | ACA30S | 380 yen |
| 40 | 29 | 48.0 | 21 | 55.0 | DV40 | 50 | ACDA40 | 403 yen | ACA40S | 437 yen |
| 50 | 32 | 60.0 | 24 | 64.5 | DV50 | 30 | ACDA50 | 460 yen | ACA50S | 495 yen |
| NEW 65 | 45 | 76.0 | 37 | 85.0 | DV65 | 10 | ACDA65 | 590 yen | ACA65S | 630 yen |

Dual Conversion Adapter (PVC Pipe VP and Directly Convertible Fittings)

* A PVC TS / DV fitting is not required for PVC pipe conversion.

NEW

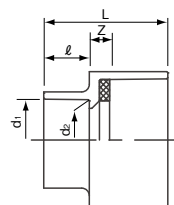
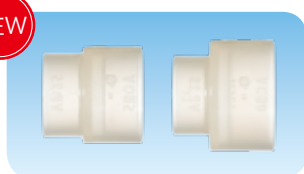

| AC Drain Nominal Diameter | Effective Length Z | Full Length L | VP Socket Size | VP Socket | | | Quantity per Package | Transparent | |
|---------------------------|--------------------|---------------|----------------|-----------|-------|----|----------------------|-------------|---------|
| | | | | d1 | d2 | ℓ | | No. | Price |
| 25 | 8 | 45 | 25 | 32.25 | 31.85 | 18 | 80 | ACVP25 | 450 yen |
| 30 | 8 | 49 | 25 | 32.25 | 31.85 | 18 | 80 | ACVP30 | 580 yen |

Unit:mm

MD Fitting Connection Adapter

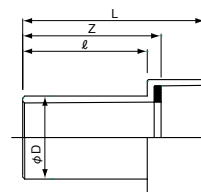
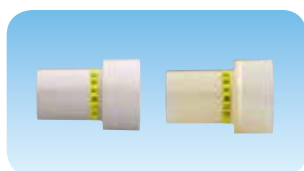

| Nominal Diameter | Effective Length Z | Spigot φD | ℓ | Full Length L | Spigot Side Connection Fitting | Quantity per Package | Ivory Colored | | Transparent | |
|------------------|--------------------|-----------|----|---------------|--------------------------------|----------------------|---------------|-----------|-------------|-----------|
| | | | | | | | No. | Price | No. | Price |
| 40 | 80 | 48 | 72 | 105 | MDaaa40 | 25 | ACMD40 | 920 yen | ACMD40S | 989 yen |
| 50 | 84 | 60 | 76 | 119 | MDaaa50 | 12 | ACMD50 | 1,047 yen | ACMD50S | 1,139 yen |

Unit:mm

Remarks: 1. Connect an AC drain pipe of the same nominal diameter to the socket side. Connect an MD fitting to the spigot side. (Do not connect a TS fitting or DV fitting to the spigot side.)
2. Do not cut the spigot and use.
3. Thermally insulate the spigot part separately.

Expansion Fitting for Vertical Pipe

NEW

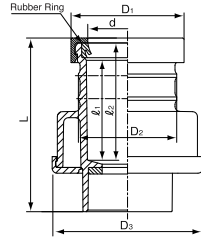
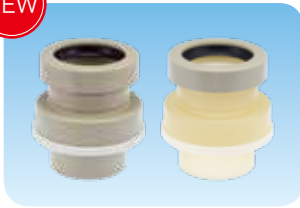

Unit:mm

| Nominal Diameter | D1 | D2 | D3 | d | L | l1 | l2 | Quantity per Package | Ivory Colored | | Transparent | |
|------------------|-----|-----|-----|------|-----|----|----|----------------------|---------------|-----------|-------------|-----------|
| | | | | | | | | | No. | Price | No. | Price |
| 30 | 69 | 60 | 92 | 48.6 | 106 | 61 | 75 | 6 | ACSS30N | 1,830 yen | ACSS30S | 2,100 yen |
| 40 | 85 | 76 | 106 | 60.8 | 113 | 62 | 78 | 5 | ACSS40N | 2,510 yen | ACSS40S | 2,890 yen |
| 50 | 106 | 89 | 123 | 77.1 | 129 | 67 | 84 | 16 | ACSS50N | 2,830 yen | ACSS50S | 3,250 yen |
| NEW 65 | 120 | 114 | 137 | 90 | 132 | 65 | 83 | 12 | ACSS65N | 3,840 yen | ACSS65S | 3,950 yen |

Remarks: 1. This is a fitting exclusively for vertical pipes. It cannot be used for horizontal pipes.
2. Please also refer to the construction standards and precautions on page 10.

Vertical Trap

NEW

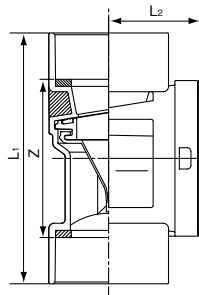

Unit:mm

| Nominal Diameter | L1 | Z | L2 | Quantity per Package | Transparent | |
|------------------|-----|-----|----|----------------------|-------------|-----------|
| | | | | | No. | Price |
| 30 | 147 | 101 | 53 | 40 | ACTT340 | 6,250 yen |
| 40 | 141 | 89 | 53 | | | |
| 50 | 162 | 90 | 53 | 40 | ACTT50 | 7,500 yen |
| NEW 65 | 195 | 115 | 53 | 20 | ACTT65 | 9,000 yen |

Remarks: 1. Nominal diameters 30 and 40 are used in combination. When connecting a 30A pipe, fix the supplied conversion adapter to the main unit socket with adhesive.
2. The item with nominal diameter of size 30 connects the conversion adapter to the main unit.
3. Please also refer to the construction standards and precautions on p.10.

How to use the conversion adapter

When connecting an AC drain pipe with a nominal diameter of 30, connect the supplied conversion adapter to the vertical trap 30-40 A.

⚠ Vertical traps require periodic inspection and cleaning and may need to be replaced. When replacing, use an inspection port unit sold separately.

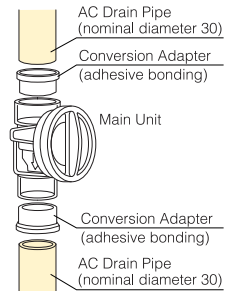

Conversion Adapter

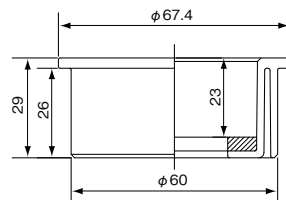

Inspection Port Unit Only (sold separately)

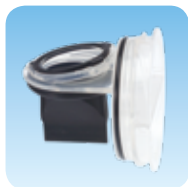

Unit for Testing if the Product is Filled with Water (sold separately)

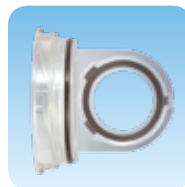

Upper Part

Unit:mm

| Product Name | Quantity per Package | Transparent | |
|--|----------------------|-------------|-----------|
| | | No. | Price |
| Inspection Port Unit | 10 | ACTTF35 | 3,500 yen |
| Unit for Testing if the Product is Filled with Water | 10 | ACTTM35 | 2,780 yen |

Remarks: 1. The inspection port unit is set in advance in the vertical trap.
2. The inspection port unit is used when repairing or replacing the unit set in the vertical trap.
3. Testing whether the product is filled with water cannot be performed simply by installing the test unit. A separate water stop jig is required.

How to Use the Unit for Testing if the Product is Filled with Water

This product is used in exchange for the inspection port unit connected to the vertical trap during the test to see if the product is filled with water.

There is no water stop function in the vertical pipe, so a separate water stop jig (commercially available) is required to perform the test to check if the product is filled with water.

(1) Turn the inspection port unit counterclockwise to unlock and pull it out.

(2) Install a unit for testing if the product is filled with water. When installing, make sure that two types of rubber packing (black) are set, and lock it by turning it clockwise while pushing the handle until it is vertical or horizontal.

(3) After stopping the water in the pipe on the floor below the trap and performing a test to see if it is filled with water, be sure to re-set the inspection port unit removed in (1). At that time, make sure that the two types of rubber packing (black) are set, and there is no abnormality in the self-closing membrane.

(2) Unit to Test if Item is Filled with Water Installation

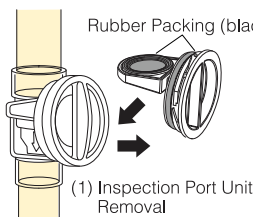

Before test if item is filled with water

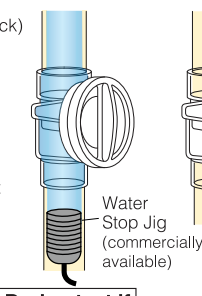

During test if item is filled with water

(3)-2 Inspection Port Unit Installation

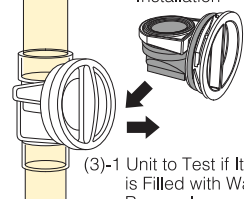

After test if item is filled with water

⚠ Since the vertical trap has a self-closing membrane, it is not possible to vent the downstream side, so use this product during a test to see if an item is filled with water.

Eslon AC Drain Pipe and Fittings Product Lineup

Related Parts

Screw-Type Cleaning Port (Rigid PVC Injection Molded Product)

Unit:mm

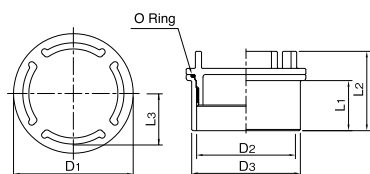

| AC Drain Nominal Diameter | D1 | D2 | D3 | L1 | L2 | L3 | Clamp Torque (N·m) | Quantity per Package | Ivory Colored | |
|---------------------------|----|----|----|----|------|------|--------------------|----------------------|---------------|-----------|
| | | | | | | | | | No. | Price |
| 20 | 41 | 27 | 32 | 19 | 42.5 | 17.5 | 2 | 200 | JNCO25N | 350 yen |
| 25 | 45 | 32 | 38 | 19 | 41.2 | 19.5 | 2 | 200 | JNCO30N | 380 yen |
| 30 | 55 | 41 | 48 | 23 | 44.5 | 24.0 | 4 | 240 | JNCO40N | 380 yen |
| 40 | 68 | 51 | 60 | 26 | 47.5 | 29.0 | 5 | 132 | JNCO50N | 440 yen |
| 50 | 84 | 69 | 76 | 36 | 57.5 | 36.0 | 5 | 68 | JNCO65N | 730 yen |
| NEW 65 | 98 | 81 | 89 | 41 | 65.0 | 42.0 | 5 | 48 | JNCO75N | 1,090 yen |

Remarks: 1. Do not use where contacting water continuously, as water condensation may occur.
2. A nominal diameter of one size larger for the AC drain is indicated on the product.

Example of using the screw-type cleaning port: AC drain nominal diameter 50 case

*The nominal diameter of the screw-type cleaning port used is one size larger than the AC drain fitting nominal diameter.

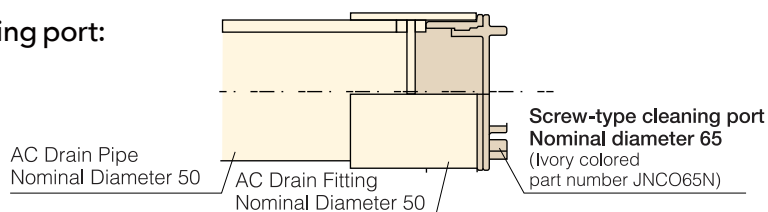

Eslon Adhesive

Please use it as a standard adhesive for AC drain pipe connection.

No.73S Blue (Colored adhesive)

Capacity:
500g can (with brush)
1kg can (with brush)



No.75S Blue N (Colored low viscosity type)

Capacity:
500g can (with brush)
1kg can (with brush)



No.73S

Capacity:
500g can (with brush)
1kg can (with brush)



No.75S

Capacity:
500g can (with brush)
1kg can (with brush)



NEW

No.73S UV (Fluorescent adhesive)

Capacity:
500g can (with brush)



Lights up when checking construction!

The adhesive shines when illuminated with a black light. You can see at a glance whether or not it has been applied even in a dark place, which is useful for confirmation of non-application.

- ⚠ Before using No.73S UV, make sure that the color shows.
- ⚠ This is an adhesive for use with drainage. Do not use it for water supply or pressurized pipes.
- ⚠ If it spills on the floor, wipe it up immediately.

Checking for non-application

Correct adhesive state



State of non-application

*Be sure to use adhesive No.73S Blue, No.75S Blue N, or No.73S UV for transparent AC drain fittings.

AC Drain Cutter

NEW

By cutting the AC drain pipe while turning it, it can be cut without damaging the foam layer.



Standard type
(For nominal diameter 20-50)



Small
(For nominal diameter 20-30)

*Can handle up to a nominal diameter of 50.



**No crushing of the foam layer!
No burrs! Handles nominal
diameters of 20-50! No chips!
No diagonal breaks!**

| Product Name | Price |
|---------------------------------|------------|
| AC Drain Cutter (standard type) | 37,300 yen |
| AC Drain Cutter (small) | 34,000 yen |
| Spare Blade | 9,200 yen |

*The AC drain cutter product is handled by SEKISUI CHEMICAL CO., LTD.

Eslon AC Drain Pipe & Fittings Construction Procedure

Construction Procedure

1 Cut



Mark the part to be cut all around, then cut at right angles to the axis of the pipe using the AC drain cutter or a PVC saw.



- ⚠ Do not use a PVC cutter, etc., as it will cause cracks and fissures.
- ⚠ In the case of a diagonal cut, drain water may enter from the end of the pipe, and there is a risk of water leaking from minute cuts on the outer surface of the pipe.
- ⚠ If there are any scratches, dents or flattened parts on the pipe, cut and remove those parts.
- ⚠ When using an AC drain cutter (shown on page 8), be sure to refer to the accompanying instruction manual. (Handles up to a nominal diameter of 50)

2 Chamfer



Chamfer the threads at the end of the pipe on both the inner and outer surfaces.

- ⚠ If it is not chamfered, the adhesive on the socket will be scraped off when connected, which may cause the thread to come off. So please be sure to chamfer the thread.

3 Cleaning Process



Wipe off with a dry cloth any dirt such as sand, earth, and dust and moisture, etc., adhering to the inside of the fittings socket or the pipe spigot.

4 Record Insertion Length



Record the insertion length shown in the table below in the pipe spigot.

Reference: Insertion length (marked line recorded length) Unit: mm

| Nominal Diameter | 20 | 25 | 30 | 40 | 50 | 65 |
|------------------|----|----|----|----|----|----|
| Insertion Length | 19 | 19 | 23 | 26 | 36 | 40 |

5 Application of Adhesive



Apply ESLON adhesive (No.73S Blue, No.75S Blue N, No.73S, No.75S, No.73S UV) evenly to the inner surface of the fittings, the pipe end surfaces and the outer surface of the pipe.

- ⚠ Be sure to use adhesive No.73S Blue, No.75S Blue N, or No.73S UV for transparent AC drain fittings.
- ⚠ Apply adhesive not only to the inner surface of the fittings and the outer surface of the pipe but also to the pipe ends. If the adhesive is not applied, drain water may enter from the pipe end and may leak due to minute cuts on the outer surface of the pipe.

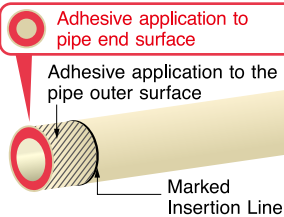

6 Insertion



<Ivory Colored>
Insert as far into the pipe as possible.

<Transparent>
Insert as far into the pipe as possible.

7 Holding (wiping off adhesive, ventilating)



Hold the pipe and fittings until the pipe can no longer come out of the fitting.
(Hold for 30 seconds or more)
Also, wipe off any protruding adhesive with a waste cloth.
Additionally, ventilate the piping thoroughly after installation.

- The outer diameter of the AC drain pipe is the same size as the outer diameter of a PVC pipe that is one caliber larger in nominal diameter, so support brackets for use with the PVC pipe can be used.
- Install the AC drain pipe supports at the same interval as the PVC pipe (VP) of the same nominal diameter.

Installation Procedure for Expansion Fittings for Vertical Pipes

1 Chamfer

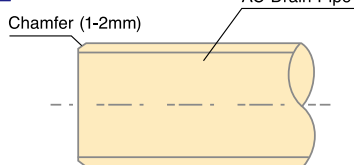

Chamfer the pipe end about 1-2mm.

2 Application of Silicone Sealant

Apply silicone sealant evenly to the pipe end surface.

- ⚠ If it is not applied, drain water may enter from the pipe end and may leak from minute cuts on the outer surface of the pipe.

3 Insertion

Please insert up to the standard insertion length for each nominal diameter in the table on the right.

| Nominal Diameter | Insertion Length |
|------------------|------------------|
| 30 | 54mm |
| 40 | 57mm |
| 50 | 64mm |
| 65 | 63mm |

Vertical Trap Installation Procedure

1 Inspection Port Unit Removal



Please remove the inspection port unit before installation.

- ⚠ If the trap is installed without removing it and the adhesive sticks to the inspection port unit, it may not work.

2 Adhesive Bonding

Bond to the AC drain pipe with adhesive.

3 Inspection Port Unit Installation



Attach the removed inspection port unit. When installing, while pushing the handle until it is vertical or horizontal, turn it clockwise to lock it.

Horizontal Pipe Installation Standard

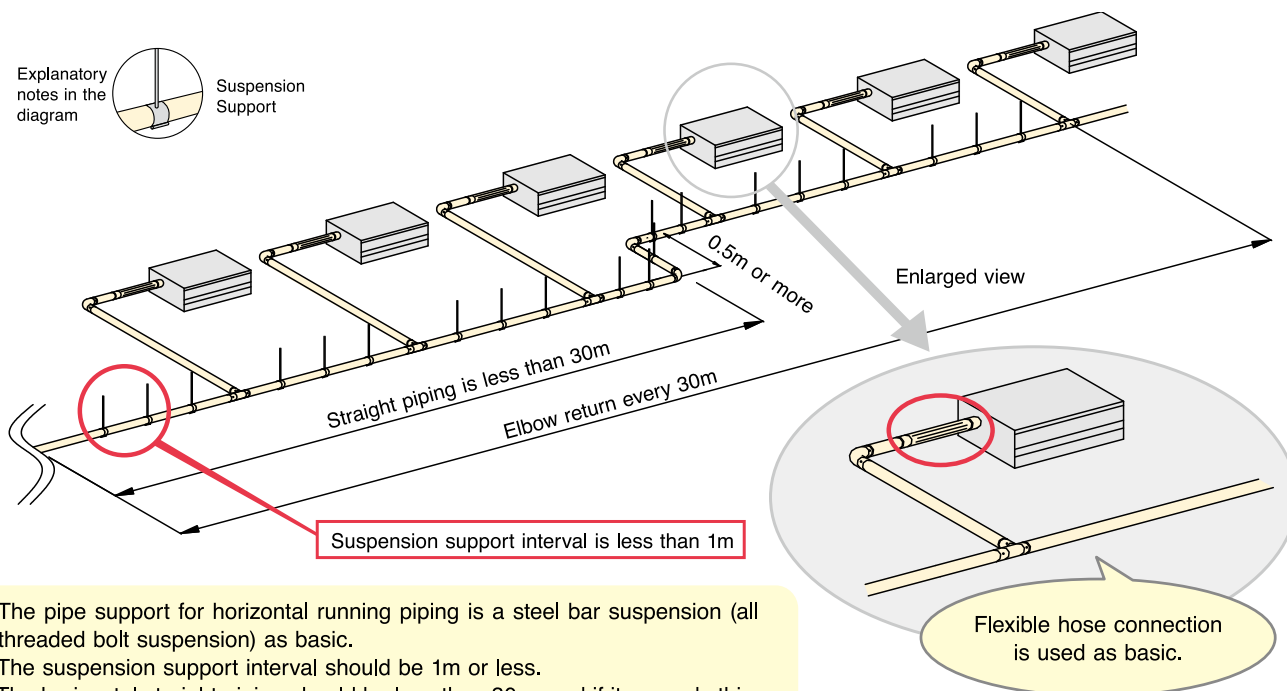

- The pipe support for horizontal running piping is a steel bar suspension (all threaded bolt suspension) as basic.
- The suspension support interval should be 1m or less.
- The horizontal straight piping should be less than 30m, and if it exceeds this, return the elbow every 30m (2 elbows or more, elbow interval 0.5m or more).

Vertical Pipe Installation Standard

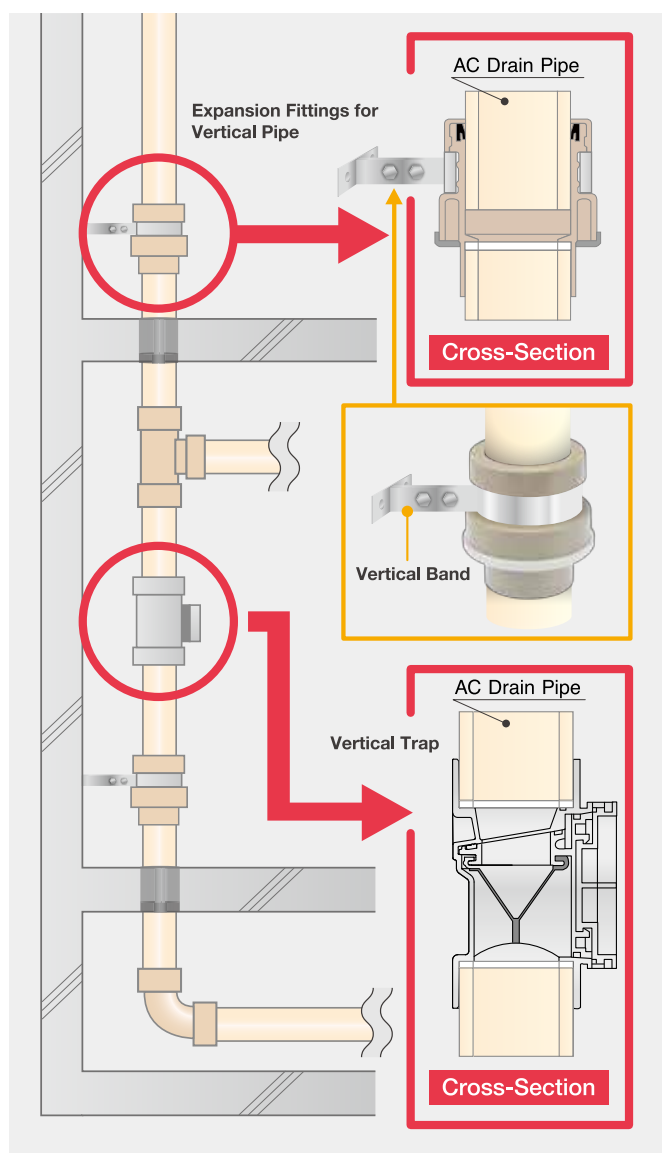

Common precautions for the vertical pipe expansion fittings and vertical traps

- This product is a fitting exclusively for vertical pipes. Do not use it for horizontal pipes.
- The direction of the arrow on the main unit is the direction of flow of the drain water. Install the pipe with the arrow in the downward direction.
- When connecting, chamfer (deburr) the inner and outer surfaces of the pipe end.
- Remove any foreign matter adhering to the pipe or packing.
- When inserting the pipe into the fitting, do not insert it with force, such as oblique insertion or hammering.
- After installation, be sure to run water through the pipe and check that water flows.

Expansion Fittings for Vertical Pipe

Installation Standard

- Install the expansion fittings on the slab at one place on each floor.
- If the pipe is not fixed to the penetration part and has no junction, install one expansion fitting every 10 m.
- Support the expansion fittings and directly under the expansion fittings.

Installation Precautions

- Application of lubricant is not required for the rubber ring part.
- Insert the AC drain pipe to the specified insertion length.
- Apply silicone sealant to the end surface of the pipe that is inserted upstream of the expansion fittings for vertical pipes.

| Nominal Diameter | Insertion Length |
|------------------|------------------|
| 30 | 54mm |
| 40 | 57mm |
| 50 | 64mm |
| 65 | 63mm |

Vertical Trap

Installation Standard

- The installation height (H) of the air conditioner and this product should be 50mm or more. However, the installation height (H) is required to be in accordance with the internal static pressure (negative pressure) of the connected air conditioner. $H \text{ [mm]} = \text{Internal static pressure (negative pressure)} \text{ [Pa]} \div 9.8 \text{ [Pa / mmAq]} + 50 \text{ [mm]}$
- This product requires periodic inspection and cleaning, and may require replacement. Provide sufficient space around the product for maintenance.

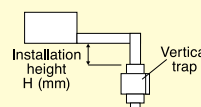

Installation Precautions

- Please attach this product to the AC drain pipe using an ESLON adhesive. Be careful of dripping due to excessive application of adhesive. If the adhesive sticks to the self-closing film, it may not work, so remove the inspection port unit before the parts are attached together with adhesive.
- When using the conversion adapter (30A), attach it to the main unit with an ESLON adhesive.

Connection Method with Different Types of Pipes

When connecting different types of pipes, be sure to use an adapter fitting at the end of the AC drain pipe.

(1) When connecting VP pipes (TS joints) of nominal diameters 20 and 25 to AC drain pipes

Connect the adapter fitting and TS fitting in combination.

⚠ The VP pipe and TS fitting require separate thermal insulation.

*This can also be used when connecting to a drain hose.

<25 Case>

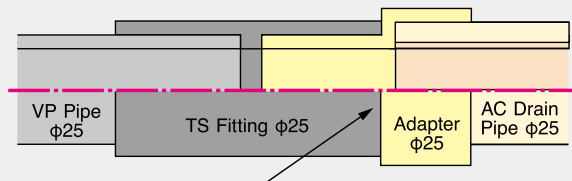

TS socket with the same nominal diameter

<50 Case>

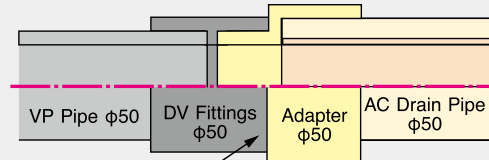

DV socket of the same nominal diameter

<40 Case>

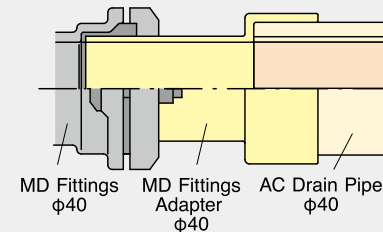

(3) When connecting MD fittings and the AC drain pipe

Connect using the MD fitting adapter.

⚠ Do not cut the spigot and use it.

⚠ Do not connect TS fittings or DV fittings to the spigot side.

⚠ The MD fitting adapter spigot part and the MD fittings require separate thermal insulation.

Eslon AC Drain Pipe and Fittings Performance

<< Design >>

● Condensation prevention performance, nominal diameter 25, pipe slope 1/50 case

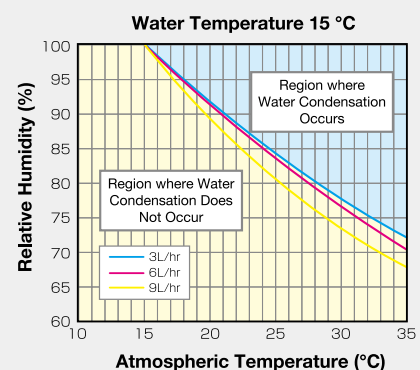
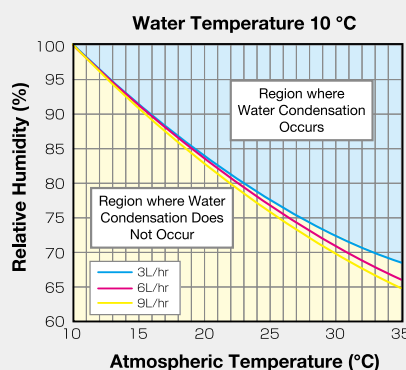
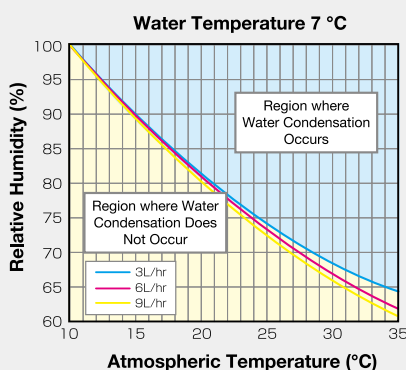

⚠ Performance of AC drain pipe and fittings when using horizontal pipe.

When using an AC drain pipe and fittings for a full pipe such as an upwardly draining part, as a general rule, provide separate thermal insulation.

1. Precautions Based on Design

- ⚠ This is a dedicated pipe for air conditioner drain piping. Never use it for pressurized pipe applications other than an upwardly draining section (1m or less).
- ⚠ In the section of inner pipe of an upwardly draining section that fills with water, water condensation may occur in the AC drain pipe and fittings single unit, so as a general rule, thermally insulate them separately.
- ⚠ This is a pipe for indoor use only. Do not use outdoors.
- ⚠ In places where the fire protection section is penetrated, fire protection section penetration handling is required using Fiblock.
- ⚠ The pipe support for horizontal running piping is a steel bar suspension (all threaded bolt suspension) as basic.
- ⚠ Horizontal straight piping should be less than 30m, and if it exceeds this, return the elbow every 30m (2 elbows or more, elbow interval 0.5m or more).
- ⚠ For a vertical pipe, handle stretching using an expansion fittings for use with vertical types at one place on each floor.
- ⚠ Under the following operating environment conditions, there is a risk of condensation on the AC drain pipe and fittings. Check the operating conditions and environmental conditions.
 - In an environment where outside air flows in, the environment around the piping is also easily affected by the outside air, which may result in temperature and humidity conditions that cause condensation.
 - In places where high temperatures and high humidity are expected even indoors (under a roof, near an outer wall, etc.), the environment around the piping may be easily affected, which may result in temperature and humidity conditions that cause condensation.
 - There is a risk of condensation in drainage water that flows at a high rate (for example, drained water from the air handling unit).

2. Storage Precautions

- ⚠ Install the AC drain pipe support at the same interval as the PVC pipe (VP) of the same nominal diameter.
- ⚠ Be sure to store the pipes and fittings indoors. When storage outdoors is unavoidable, in order to avoid direct sunlight, please use some method to ensure that they are not confined in hot air such as covering with a sheet.
- ⚠ Do not use fire in the storage area. Pipes and fittings may deteriorate due to sparks or heat.
- ⚠ Do not place solvent or paint in the storage area. If an organic solvent adheres to the pipes or fittings, they may deteriorate.

3. Transportation Precautions

- ⚠ Since the AC drain pipe has a foam layer which is soft, the packaging specification requires cardboard packaging over the full surface. Even more care should be taken when handling than with PVC (VP) pipes. Never drag or throw, etc.

4. Precautions for Installation of AC Drain Pipe and Fittings

- ⚠ Please use Eslon adhesives No.73S Blue, No.75S Blue N, No. 73S, No. 75S or No.73S UV.
- ⚠ Be sure to use adhesives No.73S Blue, No.75S Blue N, or No.73S UV for transparent AC drain fittings.
Be sure to follow the installation procedure (P.9) in the Eslon AC drain pipe and fittings catalog.
- ⚠ The connection between the AC drain pipe and the DV fittings (TS fittings) for PVC pipes may cause accumulation of water or condensation due to steps in the pipe, so please observe the following items
 - Be sure to use an AC drain pipe and AC drain fittings in combination for the AC drain piping system.
 - When connecting an AC drain pipe and a PVC pipe, use an adapter fitting (see page 5).

5. Precautions for Installation of Expansion Fittings for Vertical Pipes

- ⚠ Since the direction of the arrow on the main unit indicates the direction of drain water flow, install with the arrow pointing downwards.
- ⚠ Chamfer (deburr) the inner and outer surfaces of the pipe end.
- ⚠ Application of lubricant is not required.
- ⚠ Remove any foreign matter from the tube or packing.
- ⚠ Insert the specified amount of the AC drain pipe.

| Nominal Diameter | Insertion Length |
|------------------|------------------|
| 30A | 54mm |
| 40A | 57mm |
| 50A | 64mm |
| 65A | 63mm |

- ⚠ Do not insert forcefully, such as inserting diagonally or hammering.

6. Precautions for Installation of Vertical Trap

- ⚠ Since the direction of the arrow on the main unit indicates the direction of drain water flow, install with the arrow pointing downwards.
- ⚠ Join this product with an AC drain pipe using an ESLON adhesive.
- ⚠ Please beware of dripping due to excessive application of adhesive. If the adhesive sticks to the self-closing film, it may not work, so remove the inspection port unit before applying the adhesive.
- ⚠ After installation, be sure to check the operation of the self-closing film and check that water flows.

7. Other Precautions

- ⚠ If there are any scratches, dents or flattened parts on the pipe, cut and remove those parts.
- ⚠ If the pipe or fittings touch organic solvents such as creosote, asphalt, preservatives, waterproofing agents, ketones, castor oil or glycol ethers, they may swell and break, so do not apply or put these solvents in contact with the pipe or fittings.
- ⚠ Do not flush with chemicals such as solvents, ethanols, chlorinates, glycol ethers, or castor oil. The pipeline may be damaged and water leakage may occur. Be especially careful when cleaning the inside of the air conditioner body with liquid chemicals.
- ⚠ Do not step on or hang from the pipe.
- ⚠ Keep away from fire such as electric welding sparks, and in torch lamps and gas burners.
- ⚠ For the separation distance between gas appliances such as gas water heaters and the surrounding piping, please observe the standards stated in the gas equipment installation standards and practical guidelines (Japan Gas Appliances Inspection Association). In addition, since the standard may be relaxed depending on the model of the gas water heater, check with your gas company or gas equipment manufacturer for the specific separation distance.
- ⚠ Do not place pipes near open flames such as gas stoves.

⚠ Precautions

If the amount of adhesive used per hour exceeds the permissible amount indoors, the "Organic Solvent Poisoning Prevention Rules" will apply and you will need to be qualified as an "Organic Solvent Handling Manager". For details, check with your local Labour Safety Standards Inspection Office.

- ⚠ Since organic solvents such as adhesives are used during installation, be careful not to cause a fire.
- ⚠ When using an adhesive, be sure to provide adequate ventilation. If you get adhesive on your skin, remove it immediately. If you feel unwell or that you have something wrong physically, consult a doctor immediately.
- ⚠ In sealing materials used when piping penetrates the building foundations, walls, floors, etc., there are substances (for example, polyurethane sealants) that include plasticizers (phthalate ester, DOP, etc.) and organic solvents (xylene, toluene, etc.) that may adversely affect AC drain pipes and fittings. Do not use sealing materials containing these components as they may adversely affect PVC pipes and fittings. (Recommended products: Silicone Sealant made by Sekisui Fuller Co., Ltd, Modified Silicone Sealant)
- ⚠ Do not allow the pipe and fittings to contact directly with the covered wire (cord / covered support metal and vinyl tape) containing the plasticizer as it may immerse the pipe and fittings.
- ⚠ Please contact your nearest sales office regarding usage other than that described in this document.
- ⚠ When performing a test to check if an item is filled with water, be sure to carry it out with a hydraulic head of 3m (30kPa) and pay attention to the following items."
 - Note that if there is uneven application of the adhesive at the pipe end or if there is a gap between the fittings and the pipe, then water may enter from the pipe end.
 - When a test to check if an item is filled with water is performed, be sure to visually check and touch the connecting part.



<https://eslontimes.com/en>

* Colors of the actual products may vary from the colors shown in this printed material.
* Information in this document is subject to change without notice.

All rights reserved.

Dec. 2019 4th Edition

ESLON AC Drain Pipe and Fittings
Catalog

SEKISUI CHEMICAL CO.,LTD.
Urban Infrastructure &
Environmental Products Company

No. 05959

2020. 7. 5HU TX